

Harness the *power*

Australian
designed, made
and owned!

of **Braemar**
By SEELEY INTERNATIONAL 

for instant warmth and cosy comfort, *naturally.*

100%

highest efficiency
star ratings in Australia¹

100%

renewable hydrogen-ready²



World-leading climate control solutions

Gas Heating

Braemar
By SEELEY INTERNATIONAL 

Harness the *power* of nature.

At Seeley, we harness the power of earth and air.

There's a natural attraction between earth and air that is very powerful...

Outside, these forces of nature live all around us. But, what if we could harness this power inside too?

Our gas heating technology has been inspired by nature with ingenious design, incredible reliability and unsurpassed heating performance to create clean, natural, energy efficient heating when and where you want it.

Today, you can harness that power too.

Seeley International is renowned for world-class design and innovation, striking that delicate balance between form and function, just like nature. We have a range of traditional space heaters that deliver efficient, cosy heating for long lasting comfort.

Since day one, over 50 years ago, our company has been about challenging mindsets and stretching the imagination. Trust, reliability and innovation have been the cornerstones to success. It's no coincidence that Seeley International is the most awarded air conditioning manufacturer in Australia. We export our amazing products all around the globe.

At Seeley International, we don't settle for ordinary, and neither should you.

Frank Seeley

AM, DUniv Flin, FAICD
Founder and Executive Chairman



Harness the *ultimate*
in warmth and cosy comfort.

Nobody can like Braemar can!

Award Winning Company

Seeley International consistently wins awards each year for new product design, innovation and environmental friendliness.

Recent awards include:

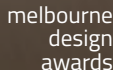

Front cover: 1. 3 to 6 star products for ducted gas heating.

2. Seeley International gas appliances at point of manufacture date, as tested in a NATA Meridian test laboratory, will comply with industry safety standards as outlined by the AGA, for use of current industry approved hydrogen/natural gas blends at that time.

Braemar
BY SEELEY INTERNATIONAL

Australian *designed*,
made and **owned!**

Australian
designed, made
and owned!



Built by Australians, for the Australian climate.

Seeley International is proudly a 100% Australian owned company, designing and manufacturing world-leading air conditioning products for Australia and the world. As Australia's largest air conditioning manufacturer, we are a global leader in developing ingenious, energy-efficient cooling and heating products. Being made in Australia, you can rely on build quality, availability of parts and after sales service. We're extremely passionate, and dedicated to strengthening the Australian economy, supporting local employment and building on the skills of our workforce.

Gas space heaters and wall furnaces

Why Braemar gas space heaters and wall furnaces?

Braemar has a range of gas space heaters and wall furnaces to suit any sized room, in a variety of configurations.



Cost savings

Leading-edge technology ensures maximised energy efficiency and savings in running costs



Efficiency

Super-efficient and economical heating with 4.8 star Braemar Eco-Superstar space heating



Safety

No emissions inside with ultra-safe flued heating



Quiet operation



Have it your way

Stylish design with flexible installation options



Environment

Lower CO₂ emissions¹⁷



Ecostar Power Flue Wall Furnaces

Ideal for heating the living area or entertainment spaces of your home, the Braemar Ecostar Power Flue Wall Furnace (PWF) delivers comfort and warmth throughout the cooler months. A great replacement for existing wall furnaces, with an energy efficiency of up to 4.5 stars.

The PWF utilises a powered flue system - safely expelling combustion emissions outside, leaving you in cosy warm comfort inside.

Range

Braemar Ecostar Power Flue PWF30

The PWF30 is a functional and stylish replacement for existing wall furnaces and is able to heat up to 95m².

Braemar Ecostar Power Flue PWF40 (commercial applications only)

The PWF40 will heat an approximate area of 80 - 120m² and is recommended for light commercial or very large domestic applications such as halls and large rumpus rooms. It is not suitable for smaller domestic applications due to the higher heat and air flow rates.



Features

- Overheat safety switches
- Thermostatic temperature control
- Self diagnostic control system
- Cool-to-touch cabinet
- Pre-heat function
- Soft-air function
- Child lock
- Inbuilt and console models
- PWF30 - natural gas only
- PWF40 - natural gas only
- Multiple fan speeds
- Electronic ignition
- Electronic flame sensing
- Power flue
- Dual gas rate
- Boost setting for rapid heating



Option to heat two rooms

Installing your wall furnace on an internal wall? An optional rear register kit means an adjoining room can also be heated.

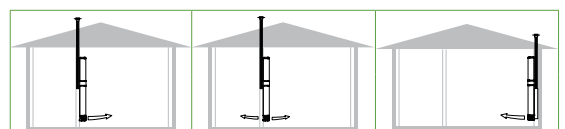

Install location	Internal wall	Internal wall	External wall
Install type	Inbuilt/Console	Inbuilt/Console	Inbuilt/Console
Flue type	Vertical flue	Vertical flue	Vertical flue
Rear register	No	Yes	No



Safety

No emissions inside with ultra-safe power flued heating



Have it your way

Stylish design with flexible installation options



Quiet operation

Ecostar Wall Furnaces



Braemar's wall furnace range is Australia's most attractive and functional. Its slim-line design makes it as discreet or as visible as you wish it to be, and with a stunning 'Ivory Sands' finish, it complements any decor.

Sized to suit you

Braemar wall furnaces are available in three models, to suit your lifestyle needs.

Braemar Eco-Superstar WF25

An ultra-efficient furnace with an impressive 4.8 star rating, the WF25 heats up to 85m² and is a perfect solution for those wanting super-efficient and economical heating.

Replace an existing wall furnace

Braemar wall furnaces are ideal for replacing existing wall furnaces, including the following models:

- Braemar D11/D12/D45/D55
- Vulcan Series 20/22/Quasar
- IXL 10862
- Convair Finesse Range

Please note: Additional kits may be required. Not suitable for direct replacement of fully-recessed models installed into double-brick walls.

Model being replaced	Flue extension kit 080802 (PWF30/40)	In-fill panel kit 085135 (WF25)	In-fill panel kit 085135 (PWF30/40)
Braemar D11/12	Kit not required	Kit not required	Kit not required
Braemar D45/55	Kit not required	Yes*	
Vulcan Series 20/22	Kit not required	Kit not required	
Vulcan Quasar	Yes	Yes*	
IXL 10862	Yes	Kit not required	
Convair Finesse	Yes	Kit not required	

Please note: when replacing existing Wall Furnaces with a WF25, a new coaxial flue system is required. Refer to flue kits required on the Flexible Installation Options chart.

* Required for inbuilt installations only.

*Refer to page 28 for technical specifications.

Console kit - standard: up to 3 m ceiling height
Console kit - long: up to 3.6 m ceiling height

Features and benefits

Eco-Superstar WF25

- Overheat safety switches
- Thermostatic temperature control
- Self diagnostic control system
- Cool-to-touch cabinet
- Pre-heat function
- Stealth® Softair® function
- Economy mode
- Child lock
- Inbuilt and console models
- Natural and propane gas
- High/low fan speeds
- Electronic ignition
- Electronic flame sensing
- Balanced flue
- High/low gas rate
- **Impressive 4.8 star rating**



Option to heat two rooms

Installing your wall furnace on an internal wall? An optional rear register kit means an adjoining room can also be heated, which effectively gives you two heaters for little more than the price of one.



Flexible installation options

Install location	External wall	External wall	Internal wall	Internal wall
Install type	Inbuilt/Console	Inbuilt/Console	Inbuilt/Console	Inbuilt/Console
Flue type	Horizontal flue	Vertical flue	Vertical flue	Vertical flue
Rear register	NA	NA	No	Yes

Eco-Superstar space heaters

Braemar Eco-Superstar's balanced flue gas space heaters boast an amazing 4.8 star gas energy rating – saving you money on running costs.

Ultra efficient balanced flue heating

Balanced flue space heating is one of the most economical forms of heating and Braemar Eco-Superstar space heaters are among the highest star rated products.

The energy efficiency of gas heaters is measured independently, and awarded star ratings. The higher the star rating, the more energy-efficient the heater is. The more energy-efficient, the more you save on running costs.

This is why Braemar Eco-Superstar space heaters have in-built technology to ensure they maximise their energy efficiency to an incredible 4.8 stars.

Sized to suit you

Braemar Eco-Superstar space heaters are available in two sizes to meet your heating needs:

- The SH18 unit heats up to 62 m²
- The SH25 unit heats up to 85 m²



SH18

SH25

Features and benefits

Standard:

- Overheat safety switches
- Thermostatic temperature control
- Self diagnostic control system
- Cool-to-touch cabinet
- High/low gas rates
- Pre-heat function
- Stealth® Softair® function
- Economy mode
- Child lock
- Inbuilt and console models
- Balanced flue
- Natural and propane gas
- High/low fan speeds
- Electronic ignition
- Electronic flame sensing

Optional:

- Rear register kit



Flexible installation options for SH18 and SH25

Install location	External wall	External wall	External wall	Internal wall	Internal wall
Install type	Inbuilt	Inbuilt	Console	Inbuilt	Inbuilt
Flue type	Horizontal flue	Vertical flue	Horizontal flue	Vertical flue	Vertical flue
Rear register	NA	NA	NA	No	Yes



Space Heater

Model	Dimensions (mm)				Star rating	Gas Input MJ/hr		Heat output kW	Area that can be heated (m ²)*		
	H	W	D (inbuilt)	D (console)		Low	High		Cold	Cool	Mild
Eco-Superstar SH18	900	495	167	262	4.8	12	18	4.3	40	54	62
Eco-Superstar SH25	1050	495	167	262	4.8	17	25	6.0	57	75	85

*Area that can be heated is an indication only and is based on brick veneer construction, insulated walls and ceilings, 2.4m ceiling height and suitable window coverings. Precise heating capacity calculation should be undertaken to determine the correct unit required for your specific application.

Wall Furnace

Model	Dimensions (mm)				Star rating	Gas input (MJ/hr)		Heat output kW	Area that can be heated (m ²)*		
	H	W	D (inbuilt)	D (console)		Low	High		Cold	Cool	Mild
Eco-Superstar WF25	1800	495	167	262	4.8	17	25	6.0	57	75	85
Ecostar Power Flue PWF30	2050	498	167	260	4.5	20	28	6.4	65	85	95
Ecostar Power Flue PWF40	2050	498	167	260	4.2	25	38	8.6	80	100	120

*Area that can be heated is an indication only and is based on brick veneer construction, insulated walls and ceilings, 2.4m ceiling height and suitable window coverings. Precise heating capacity calculation should be undertaken to determine the correct unit required for your specific application.



Warranty terms and conditions

Space heaters and wall furnaces

Braemar space heaters and wall furnaces are backed by a 2 year warranty, and 10 year heat exchanger warranty.



IMPORTANT

Remember to always use qualified, licensed installers who have been trained to install Braemar products. While Seeley International stands by its product quality, a poorly installed product may not operate properly and can even be dangerous. So be sure to buy your product from a reputable dealer (visit seeleyinternational.com or call 1300 136 515 to find a dealer) and make sure your installer is fully qualified and trained.



Frequently Asked Questions

Do I need to get the system serviced?

Yes. Regular servicing in accordance with the owners manual is required for manufacturers warranty to be upheld. Dirt and dust can accumulate over time if not maintained, making your heater work harder. Regular servicing ensures ongoing efficiency and prolongs the lifespan of your system.

Can ducted gas heating and evaporative cooling share ducts?

No. Evaporative cooling requires a greater volume of air than ducted gas heating, so therefore requires larger duct work.

Will ducted gas heating heat my home quickly?

Yes. Natural gas systems provide instant warmth, whereas electric based systems like reverse cycle take longer to warm up.

Should I install under-floor or ceiling ducts?

The most suitable duct placement will be determined largely by your home's construction and personal preference. Factors to consider include sufficient room under flooring, furniture placement, ceiling heights, number of storeys and if you have a cooling combination. The placement of ducts is crucial to delivering consistent, energy efficient heating. Your installer should advise of the best design and solution.





Harness the *power* of nature



BREEZAIR

Ducted Evaporative Air Conditioning

BRAEMAR

Ducted Evaporative Air Conditioning | Ducted Gas Heating
Reverse Cycle Air Conditioning | Gas Wall Furnaces and Space Heaters

THE CLIMATE WIZARD

Micro-Core[®] Technology

SUPERCOOL

Ducted Evaporative Air Conditioning

COOLAIR

Ducted Evaporative Air Conditioning

COOLERADO

Indirect Evaporative Air Conditioning

AIRA

Direct and Indirect Evaporative Air Conditioning | Ducted Gas Heating
Commercial Gas Space Heating | Energy Recovery Systems

INTEGRATED COMFORT INCORPORATED (ICI)

Dual Cool[®] Patented Dual Evaporative pre-cooling products

seeleyinternational.com/braemar

1300 360 815

2022

Seeley International Pty Ltd

ABN 23 054 687 035

112 O'Sullivan Beach Road, Lonsdale, SA 5160

Phone: (08) 8328 3850 Fax: (08) 8328 3950

Email: enquiries@seeleyinternational.com

seeleyinternational.com

Information in this brochure was correct at the time of preparation. E & OE



With the generous support of our Australasian dealers we are proud to be the National Variety Bash partner supporting kids in need across Australia.

